

STOCKHOLM VASOMULTI® LA001BI

CE EN 997:2015

GLOBO

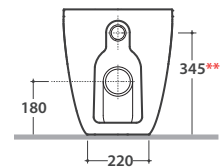
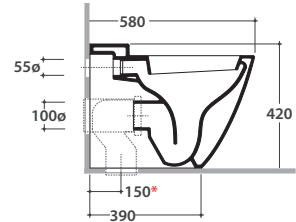
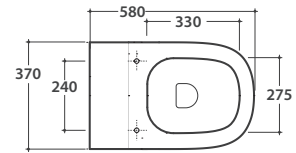

Effetto antibatterico su ceramica BATAFORM®
Ceramic antibacterial effect BATAFORM®



Prodotto smaltato con CERASLIDE®
Glazed product with CERASLIDE®



Scarico ottimizzato a 4/2,6 litri
Drain 4/2,6 lt

Cod. **LA001BI**

Vaso a terra 58.37 h42 cm con carico e scarico regolabile MULTI. Installazione filo parete.
Scarico 4 / 2,6 Lt. Completo di FISSAGGIOGHOST®. Peso 27 Kg
Floor mounted Wc 58.37 h42 cm with adjustable water inlet/outlet MULTI. Back to wall installation.
Drain 4/2,6 Lt. FISSAGGIOGHOST® Fixing kit included. Weight 27 Kg



Copriwater con sistema di cerniere a sgancio rapido
Seat-cover with hinge system for quick release



Trattamento antibatterico per sedili in versione bianco lucido
Antibacterial treatment on toilet seats in shiny white

Cod. **LAR19BI**

Coprivaso rimovibile in duroplast con chiusura tradizionale. Peso 3,5 Kg
Removable duroplast seat-cover with traditional closing system. Weight 3,5 Kg

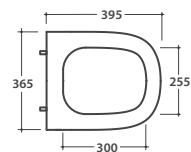
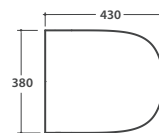

Cod. **LAR20BI**

Coprivaso rimovibile in duroplast con chiusura rallentata. Peso 3,5 Kg
Removable duroplast seat-cover with soft-closing system. Weight 3,5 Kg

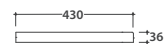

Cod. **VA077 ***

Raccordo per scarico a pavimento regolabile da 6 a 12 cm. Peso 0,3Kg
Elbow pipe for floor drain. Adjustable 6/12 cm. Weight 0,3 Kg



Cod. **VA079 ***

Curva tecnica per lo scarico a pavimento regolabile da 13 a 16 cm. Peso 0,3Kg
Elbow pipe for floor drain. Adjustable 13/16 cm. Weight 0,3 Kg



Cod. **VA078 ***

Raccordo per scarico a pavimento regolabile da 17 a 21 cm. Peso 0,3Kg
Elbow pipe for floor drain. Adjustable 17/21 cm. Weight 0,3 Kg

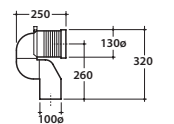
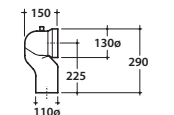
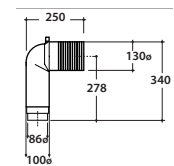

Cod. **VA086 ****

Raccordo eccentrico per entrata acqua h 33 cm o h 36 cm. Peso 0,1Kg
Eccentric pipe for water inlet 33/36cm. Weight 0,1 Kg

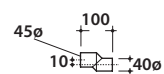

Cod. **VA076**

Raccordo per scarico a parete cm. 35
Pipe for wall drain 35cm.

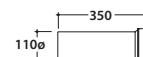

Cod. **VA132**

Riduttore flusso di scarico.
Flow reductor.